



Installation of BLUESTOP

Introduction

BLUESTOP is a swellable strip applied waterstop used to seal below grade, non-moving concrete joints. Comprised of bentonite clay and butyl rubber, the waterstop expands up to three (3) times its original volume when in contact with water. This expansion creates a long lasting compression seal. BLUESTOP does not require split formwork, making the installation efficient and simple. In addition to its installation and sealing advantages, BLUESTOP is conveniently packaged six (6) rolls per carton. The 3/4" x 1" profile is provided on 16'-8" rolls weighing less than 7 pounds each.

Forming Requirements

BLUESTOP is installed after the form is stripped from the first pour and before the second pour is made. Therefore, splitting of the form is not required. A keyway may be formed with a slight draft angle at the joint face to accept the BLUESTOP. Installing BLUESTOP in a formed keyway will reduce the risk of the profile shifting during the placement of the concrete but may increase the chance of BLUESTOP being exposed to pooling water.

The expansion process begins immediately when BLUESTOP contacts water.

Therefore installation of BLUESTOP should be made just prior to the second placement of concrete. This will reduce the chance for premature expansion of BLUESTOP due to moisture exposure. BLUESTOP should be protected from water exposure where construction practice dictates a delay between installation and concrete placement.

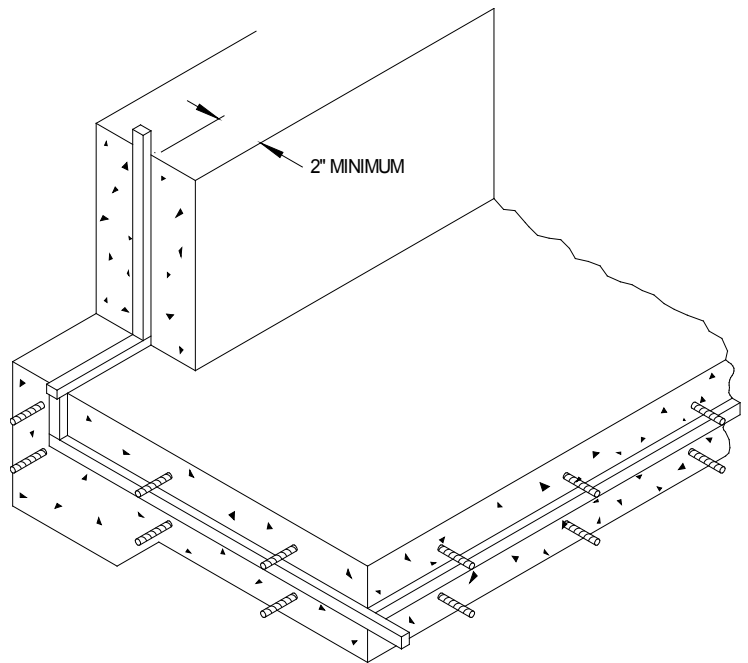

Splicing

BLUESTOP should be spliced by butting the ends of the waterstop together to ensure no separation and no air pockets. Do not overlap the ends of the waterstop. 90° corners, crosses, and T's can be accomplished in a similar manner. It is not necessary to miter cut the BLUESTOP at these intersections. The pliable nature of BLUESTOP permits it to be

bent around corners eliminating a 90° splice if desired. Place in maximum practical lengths to minimize splicing.

Bonding to Concrete

Remove all dust, oil, laitance, etc... from concrete surface prior to adhering BLUESTOP. Concrete surface should be smooth, even and dry, and cured for a minimum 24 hours prior to application of BLUESTOP.

Brush apply one coat of BLUESTOP PRIMER ADHESIVE two (2) inches wide continuously along the joint. Allow the primer adhesive to dry for two (2) hours prior to application of the BLUESTOP. The primer adhesive provides a dust free, tacky surface to improve the adhesion of BLUESTOP to the concrete. Press waterstop firmly and continuously in place over primed area.

BLUESTOP can be mechanically fastened to concrete using concrete nails in vertical or overhead applications. This should be done in addition to using the primer adhesive. Suggested fastener spacing is approximately 12" on center.

Important Precautions

BLUESTOP should be used in below grade, non-moving joints only. BLUESTOP is not appropriate for expansion joint applications. BLUESTOP protects a joint from water migration by creating a compressive seal within the joint. Any movement will diminish this compressive seal and compromise its effectiveness. The hydrophilic agents in BLUESTOP require the presence of moisture to initiate and maintain expansion.

In order to avoid cracking and/or spalling of the concrete caused by the expansion pressure of BLUESTOP, a minimum of 2" of concrete coverage is recommended. Increase this coverage if lightweight or low strength concrete (< 3500 PSI compressive strength) is used.

BLUESTOP should be applied the same day as the primer adhesive is applied. Inspect BLUESTOP for premature swell, discontinuity, and debris contamination immediately prior to the 2nd pour of concrete. If swelling and/or damage has occurred, remove and replace the material with new. Do not remove separation paper from BLUESTOP until just prior to 2nd pour concrete. Store material in a cool, dark, dry environment.

